



Rectory Close, St. Leonards-On-Sea TN38 0TW

Guide price £160,000



*GUIDE PRICE £160,000 - £170,000 * Spacious THREE BEDROOM APARTMENT set on the FIRST FLOOR of this PURPOSE BUILT BLOCK which is conveniently positioned close to local shops and transport links at Silverhill and Bohemia. Situated in a private road within easy reach of St. Matthews Gardens residents gardens and Alexandra Park. Entering through a generous entrance hall, the accommodation here is arranged as a BRIGHT LIVING SPACE which enjoys a front aspect measuring 15'3 x 10'11 while the FITTED KITCHEN sits at the rear offering ample storage space along with ample room for a full dining table. There are THREE BEDROOMS, two of which are double rooms, together with a FAMILY BATHROOM and separate w/c. Being sold with a LONG LEASE, SHARE OF FREEHOLD, RESIDENTS PARKING to the front of the property and COMMUNAL GARDENS this fantastic property is not one to be missed.

FIRST FLOOR
876 sq.ft. (81.4 sq.m.) approx.

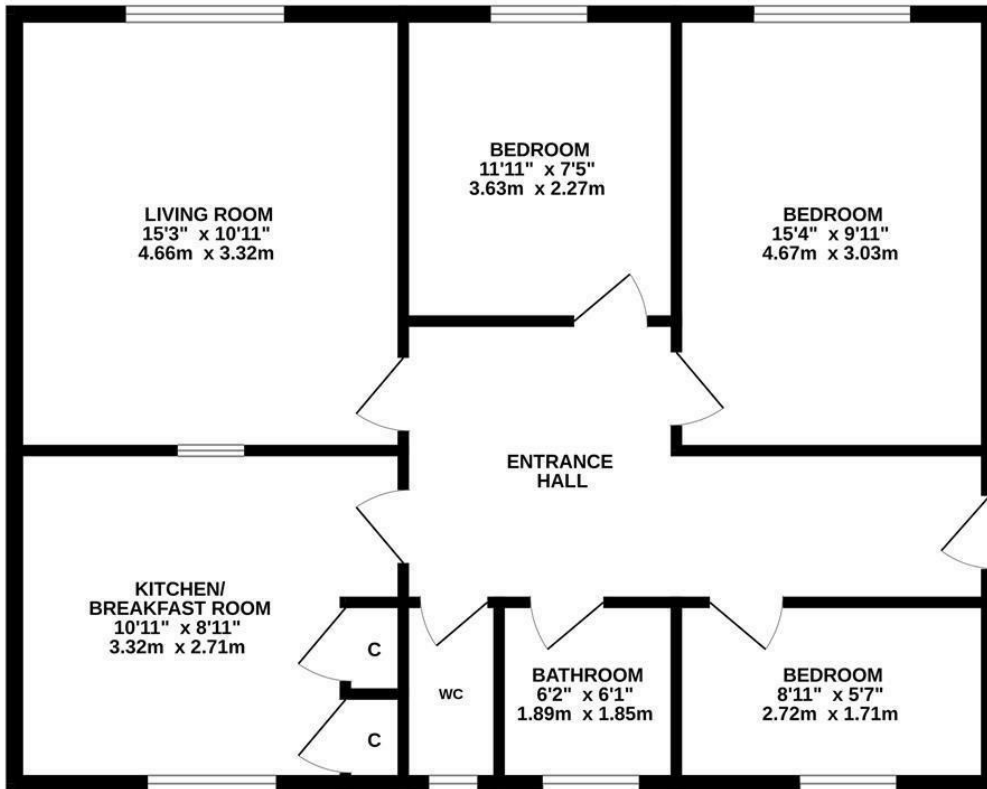

TOTAL FLOOR AREA : 876 sq.ft. (81.4 sq.m.) approx.

Whilst every attempt has been made to ensure the accuracy of the floorplan contained here, measurements of doors, windows, rooms and any other items are approximate and no responsibility is taken for any error, omission or mis-statement. This plan is for illustrative purposes only and should be used as such by any prospective purchaser. The services, systems and appliances shown have not been tested and no guarantee as to their operability or efficiency can be given.
Made with Metropix ©2025

